

MODEL POWERED BY 4 STRANDS OF 1/8" FLAT RUBBER.

IF THE MODEL SHOULD STALL IN THE TEST FLIGHT A LITTLE WEIGHT MAY BE GLUED TO THE BACK OF BODY FORMER NO.1.

1/16" X 1/8" TRAILING EDGE TAPERED AS SHOWN.

BLACK THREAD BANANA OILED HERE TO SHOWAILERON.

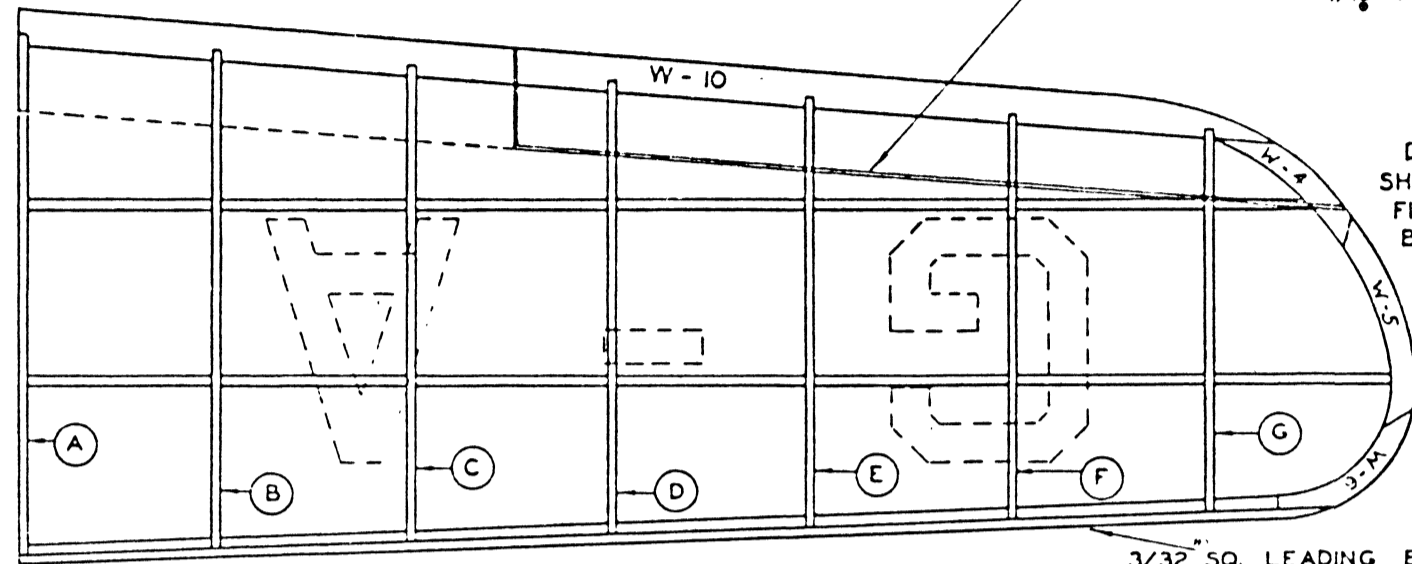

DOTTED LINES SHOW UP LANDING FLAPS ON THE BOTTOM OF THE WINGS.

3/32" SQ. LEADING EDGE

TRAILING EDGE AND CENTER SPARS CUT FROM PRINTED SHEET.

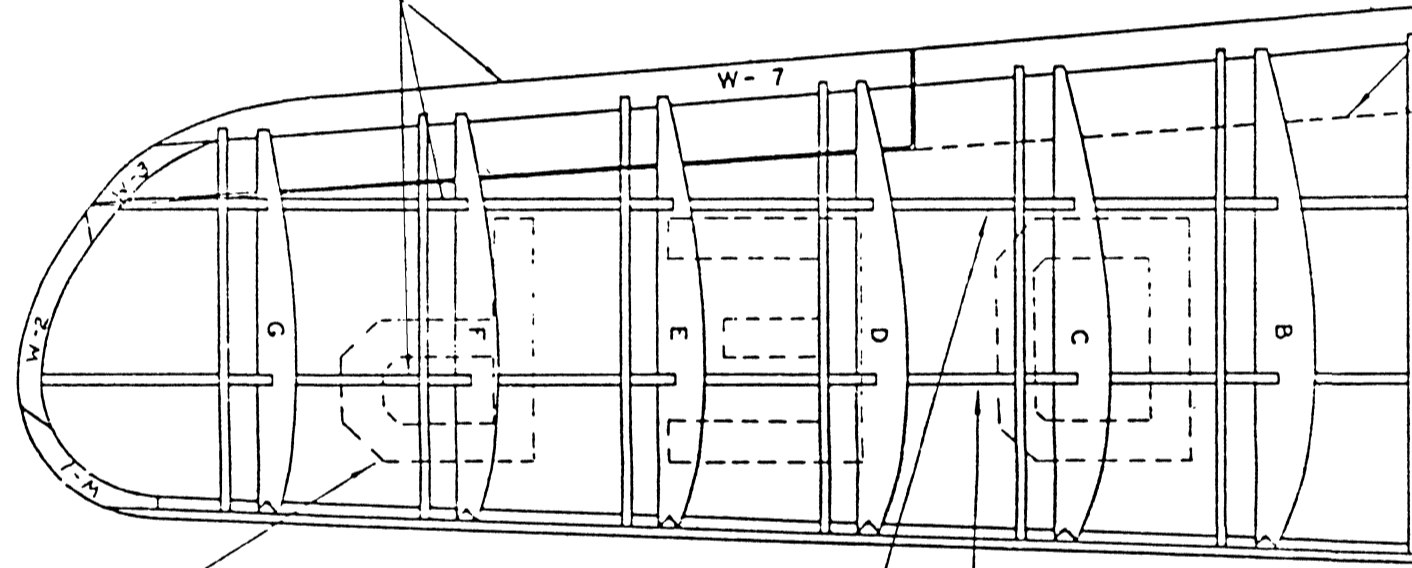

LICENSE LETTERS CUT FROM GUMMED SHEET AND STUCK TO WING AS SHOWN ON PLAN.

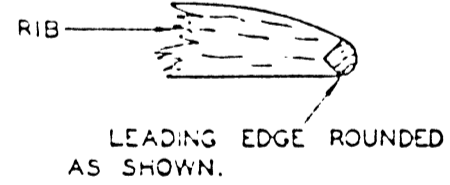

MAKE TWO OF EACH RIB EXCEPT RIB A OF WHICH SIX ARE REQUIRED.

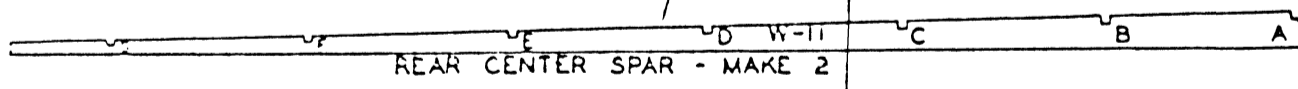

REAR CENTER SPAR - MAKE 2



FRONT CENTER SPAR - MAKE 2

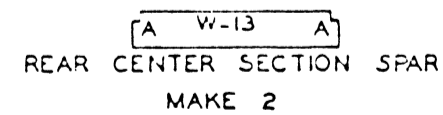

REAR CENTER SECTION SPAR MAKE 2

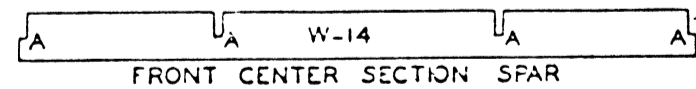

FRONT CENTER SECTION SPAR MAKE 1

RIB IS SLANTED TO FIT SHAPE OF FUSELAGE.

1/16" SQ. ROUNDED USED TO BRACE THE LANDING GEAR.

WING TIPS CUT FROM 1/16" SHEET BALSAA.

DIHEDRAL ANGLE GIVES MODEL LATERAL STABILITY IN FLIGHT.

COLOR SCHEME: FUSELAGE - BLUE WING AND TAIL ASSEMBLY - ORANGE

CROSS SECTION VIEW OF WHEEL AND PANT.

TOP VIEW OF PANT

PIN SERVES AS AXLE

PANTS BUILT FROM 1/8" SHEET BALSAA.

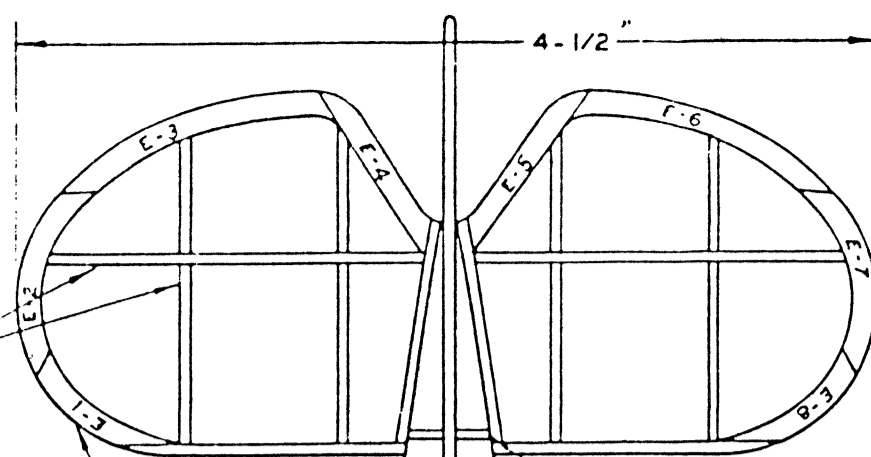

1/16" SQ. BALSAA

1/16" PRINTED SHEET

NOTE: STRINGERS NOT SHOWN IN TOP AND SIDE VIEW TO AVOID CONFUSION.

EACH HALF OF BODY FORMER SHOWN. MAKE TWO OF EACH.

WING STEPS CUT FROM GUMMED SHEET.

CELLOPHANE USED TO COVER COCKPIT ENCLOSURE.

OTHER HALF OF WING SHOWN JOINS HERE.

CUT DASHBOARD FROM PLAN AND GLUE TO FORMER 2.

DASHBOARD

MAKE CENTER SECTIONS OF WING OVER PLAN OMITTING THE FRONT CENTER SPAR.

IF FUSELAGE IS COVERED BEFORE THE CENTER SECTIONS ARE CEMENTED TO IT SLITS ARE CUT IN THE PAPER SO THE FRONT CENTER SPAR MAY BE PUSHED THROUGH. THE SPAR IS THEN CEMENTED TO NOTCHED RIBS AGAINST THE FRONT OF BODY FORMER NO. 3 AND ON THE BACKBONE STRIP.

REAR HOOK DETAIL

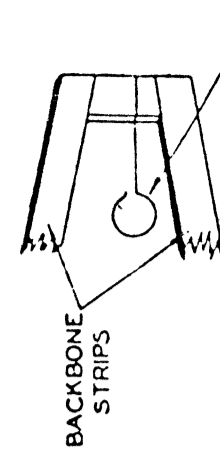

BACKBONE STRIPS

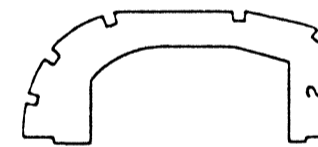
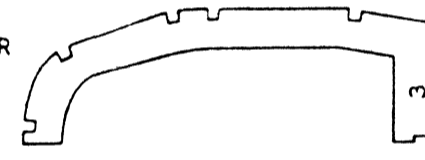
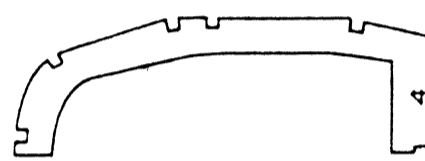
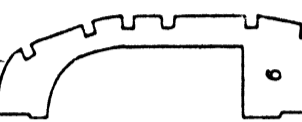

1/16" SQ. BALSAA

ALL STRINGERS ARE 1/16" SQ. BALSAA

1/16" X 3/16" BALSAA BACKBONE STRIPS

TIP OF SPINNER SHAPED FROM 1/16" SHEET BALSAA.

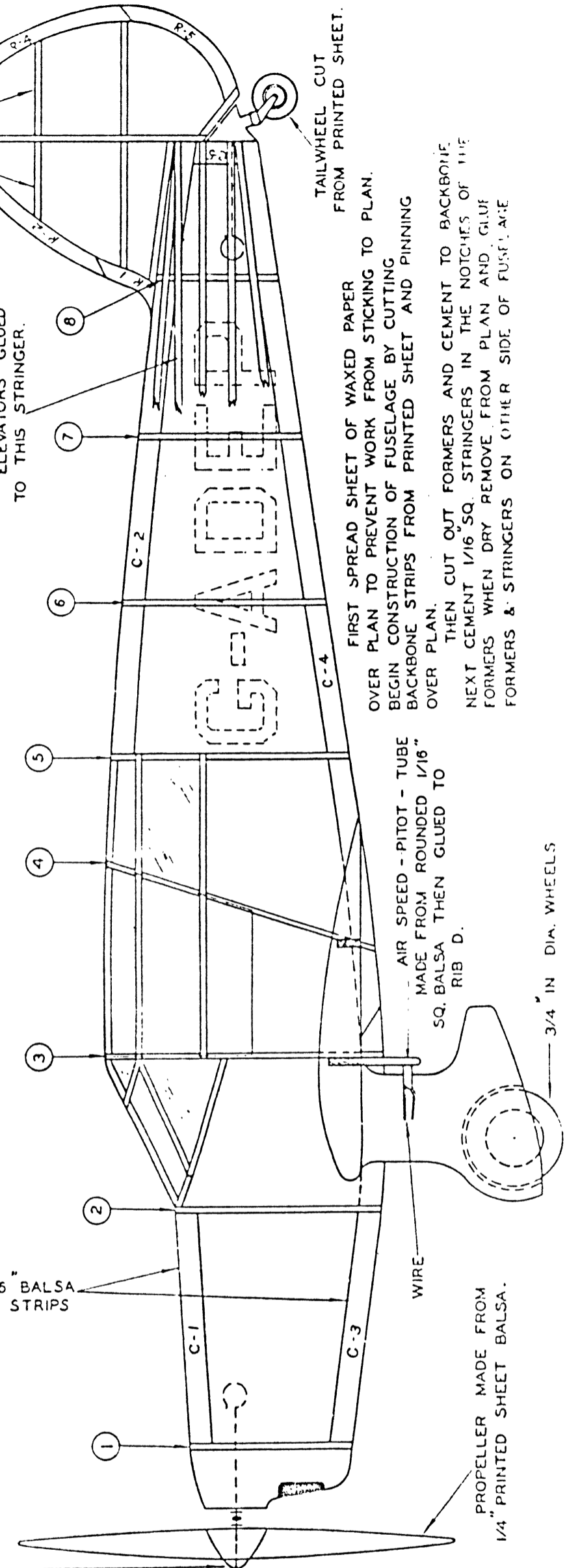

ELEVATORS GLUED TO THIS STRINGER.

TAILWHEEL CUT FROM PRINTED SHEET

FIRST SPREAD SHEET OF WAXED PAPER OVER PLAN TO PREVENT WORK FROM STICKING TO PLAN. BEGIN CONSTRUCTION OF FUSELAGE BY CUTTING BACKBONE STRIPS FROM PRINTED SHEET AND PINNING OVER PLAN. THEN CUT OUT FORMERS AND CEMENT TO BACKBONE. NEXT CEMENT 1/16" SQ. STRINGERS IN THE NOTCHES OF THE FORMERS WHEN DRY REMOVE FROM PLAN AND GLUE FORMERS & STRINGERS ON OTHER SIDE OF FUSELAGE.

AIR SPEED - PITOT - TUBE MADE FROM ROUNDED 1/16" SQ. BALSAA THEN GLUED TO RIB D.

3/4" IN DIA. WHEELS

PROPELLER MADE FROM 1/4" PRINTED SHEET BALSAA.

FOR FLYING USE 5 IN. MACHINE CUT PROPELLER. SCALE PROPELLER MAY BE USED FOR EXHIBITION PURPOSES.

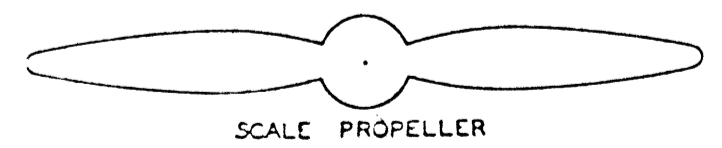

SCALE PROPELLER

PERCEVAL GULL

POPULAR BRITISH CASH PLANE

WING SPAN - 18 IN.

LENGTH - 12 - 1/4 IN.

