

GRUMMAN HELLCAT F6F-3

The Japs were introduced to a new airplane when our Navy raided the important Jap base of Marcus. The Hellcat, latest of our Navy's fighters, is one of the speediest ever to run from a carrier deck. Many are in service with the British Fleet Air Arm.

Speed is not the Hellcat's only virtue. It is highly maneuverable, a quality requested by our veteran fighter pilots who asked what they would like to have in a new fighter. One reason for its lightning climb, fast acceleration and small turning radius is the wing loading, which is unusually low for a plane in its class. Actual performance figures are secret.

The Hellcat is powered by the Pratt & Whitney 2000 H.P. Twin Wasp, an 18 cylinder, double row, air-cooled radial engine, equipped with a two-speed, two-stage supercharger.

Armament is probably six .50 cal. guns in the wings. Self-sealing tanks and plenty of armor plate help the plane to "take it" as well as "dish it out."

Wings fold back for compact storage on carriers. Landing gear twists and folds back into bottom of wing.

The Hellcat has a span of 42 ft. 10 in. and an overall length of 33 ft. 10 in.

Some of the planes in service have regulation Navy gray-blue on top and sides and light gray on bottom with an irregular separation line. Others have all top areas Navy gray-blue, side areas light blue and bottom areas gray, with a blended irregular separation line between each.

IDENTIFICATION

Low-mid wing monoplane with wings tapered from root to squarish tips. Radial engine with air scoops at bottom, giving oval appearance to cowl front. High cabin is directly above wing.

Horizontal tailplane has trailing edge straight and leading edge swept back to rounded tips. Tapered fin-rudder with squarish top.

"PLANE FACTS"

16. CODING SYSTEM OF ARMY AND NAVY AIRCRAFT

The first letter in an Army designation indicates the type. This is followed by a hyphen and the accepted design number or model. Modifications of the same model are designated by a letter after the design number. Thus the B-17E is a bomber of the 17th design accepted by the Army with five modifications.

ARMY TYPES

A—Light Bombardment
B—Med and Heavy Bomb.
C—Transport
G—Glider
O—Observation
O—Observation
P—Patrol
R—Multi-Engine Trans.
S—Scout
T—Torpedo
TB—Twin-engine Bomber
TG—Twin-engine Transport
W—Wing

NAVY TYPES

B—Bomber
F—Fighter
H—Ambulance
J—Utility
N—Trainer
O—Observation
P—Patrol
R—Multi-Engine Trans.
S—Scout
T—Torpedo
TB—Twin-engine Bomber
TG—Twin-engine Transport
W—Wing

ARMY DESIGNATION

The first letter in an Army designation indicates the type. This is followed by a hyphen and the accepted design number or model. Modifications of the same model are designated by a letter after the design number. Thus the B-17E is a bomber of the 17th design accepted by the Army with five modifications.

NAVY DESIGNATION

A letter is assigned to designate each aircraft manufacturer and is placed after the type designation. A hyphen is next followed by a number which indicates modifications of that same design. Different designs of the same type produced by the same manufacturer are indicated by numbers before the manufacturer's letter. Thus the PB2V-2 is a patrol bomber of the second design made by Convair with two modifications.

ARMY TYPES

A—Light Bombardment
B—Med and Heavy Bomb.
C—Transport
G—Glider
O—Observation
O—Observation
P—Patrol
R—Multi-Engine Trans.
S—Scout
T—Torpedo
TB—Twin-engine Bomber
TG—Twin-engine Transport
W—Wing

NAVY TYPES

B—Bomber
F—Fighter
H—Ambulance
J—Utility
N—Trainer
O—Observation
P—Patrol
R—Multi-Engine Trans.
S—Scout
T—Torpedo
TB—Twin-engine Bomber
TG—Twin-engine Transport
W—Wing

ARMY TYPES

A—Light Bombardment
B—Med and Heavy Bomb.
C—Transport
G—Glider
O—Observation
O—Observation
P—Patrol
R—Multi-Engine Trans.
S—Scout
T—Torpedo
TB—Twin-engine Bomber
TG—Twin-engine Transport
W—Wing

NAVY TYPES

B—Bomber
F—Fighter
H—Ambulance
J—Utility
N—Trainer
O—Observation
P—Patrol
R—Multi-Engine Trans.
S—Scout
T—Torpedo
TB—Twin-engine Bomber
TG—Twin-engine Transport
W—Wing

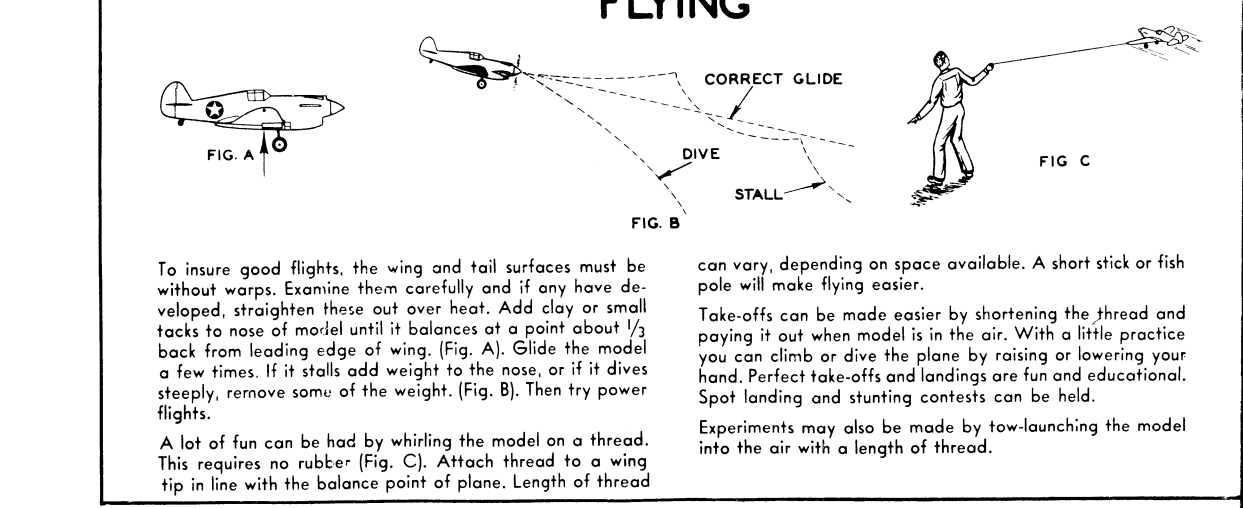
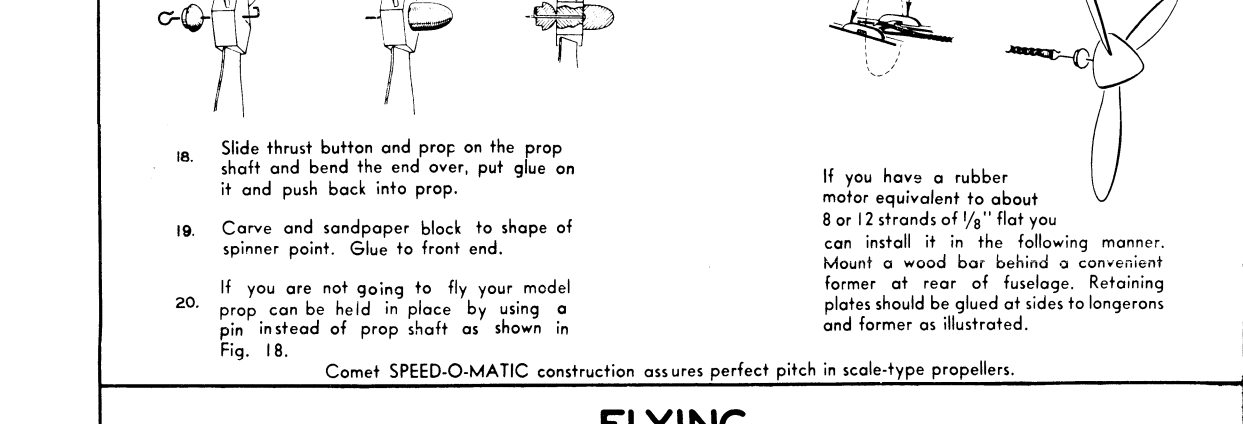
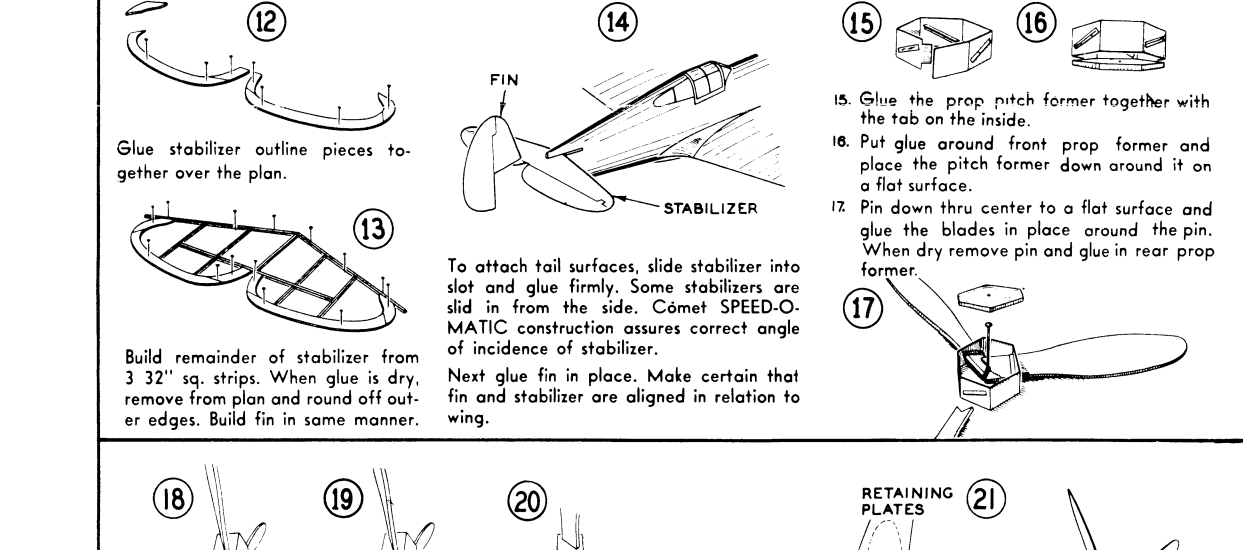
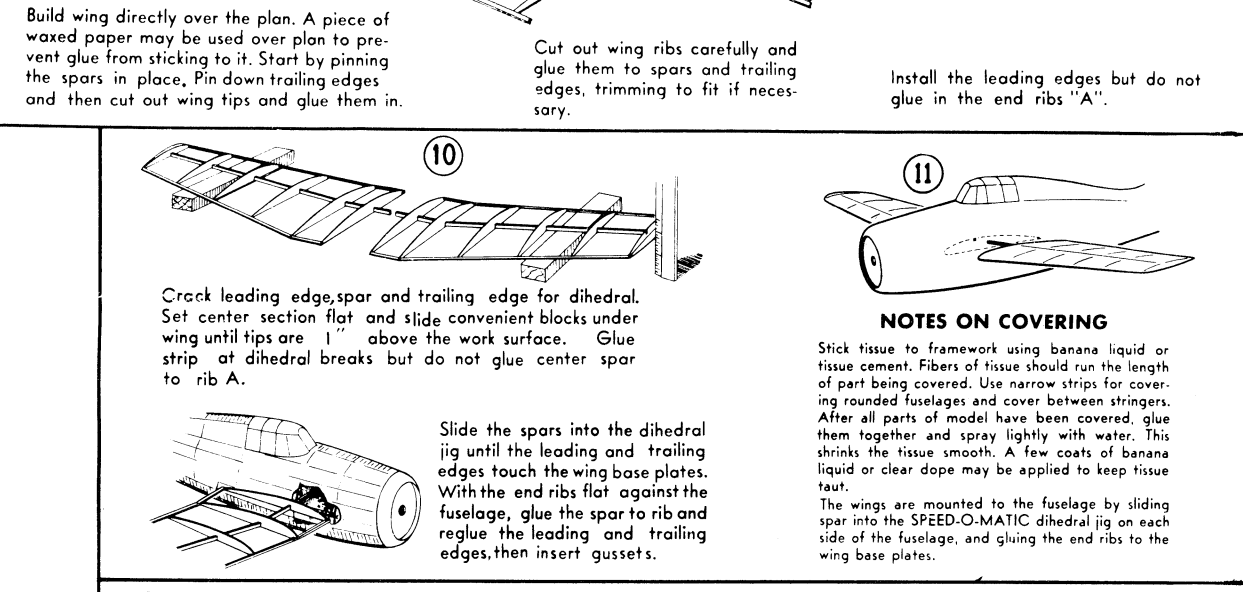
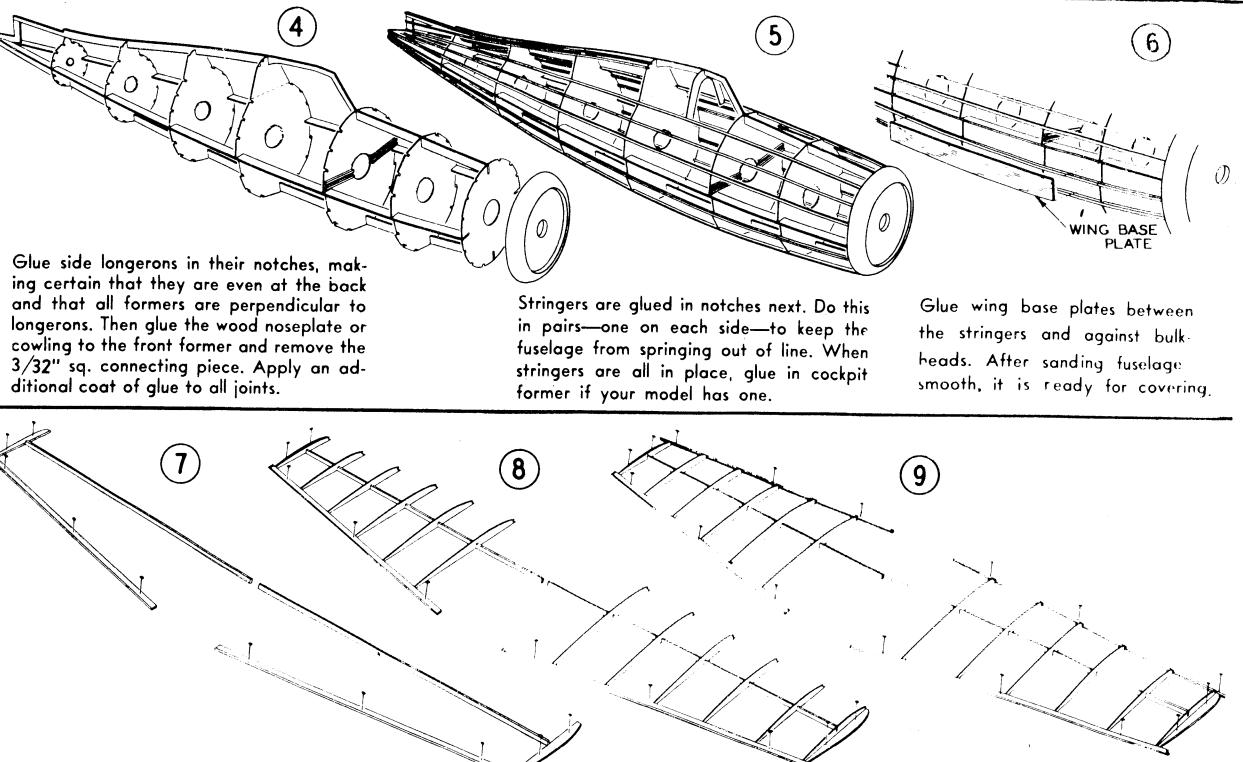
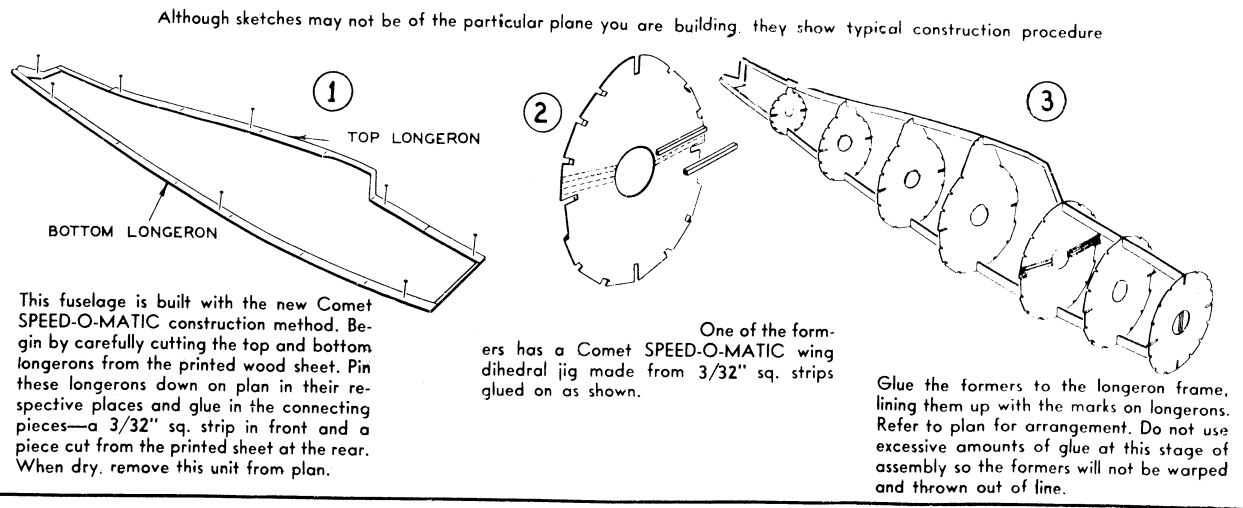

GRUMMAN "HELLCAT" F6F-3

WINGSPAN 24 INCHES LENGTH 19 INCHES

KIT NO. 3503 DRAWN BY *Orville G. Adams*

COMET MODEL HOBBYCAST CORP., CHICAGO, ILL.

COMET