

WING LEADING EDGE IS MADE FROM 1/16 BY 1/8 HARD Balsa STICK - SANDPAPER TO A SMOOTH HALF ROUND SHAPE.

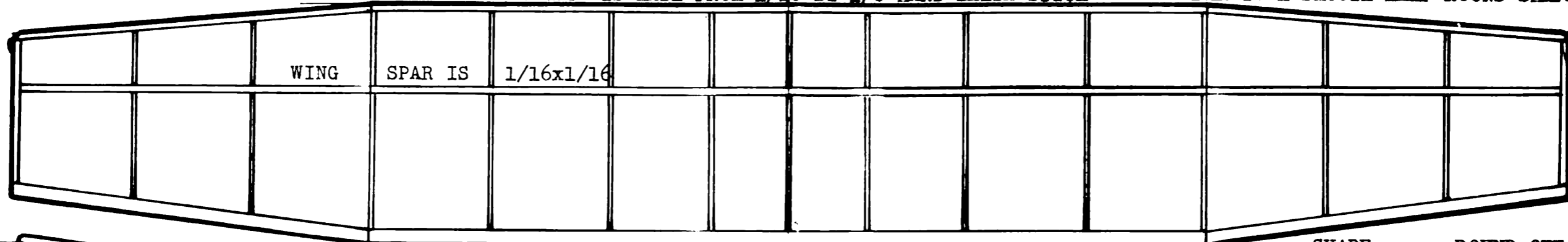

WING TRAILING EDGE IS MADE FROM 1/16 BY 1/8 Balsa STICK - TAPER TO TRIANGLE-<sup>1</sup> SHAPE.

ROUND OFF LEADING EDGE.

DIHEDRAL

LEADING EDGE

EITHER CARVE A PROPELLER WITH THE SPINNER INTEGRAL, FROM SOFT PINE OR HARD Balsa OR SELECT A PLASTIC COMMERCIAL ONE TO CUT DOWN TO SIZE.

WING DIHEDRAL IS ONLY ON TAPERED TIPS. AFTER ASSEMBLY OF L.E., T.E., AND RIBS, BLOCK UP TIPS, PUT IN SPAR.

THE HORIZONTAL TAIL IS BUILT FLAT DIRECTLY OVER THIS PLAN. ALL STICKS ARE 1/16TH SQUARE Balsa. USE A HARD PIECE FOR THE LEADING EDGE, AND LIGHT WEIGHT Balsa FOR ALL THE REST.

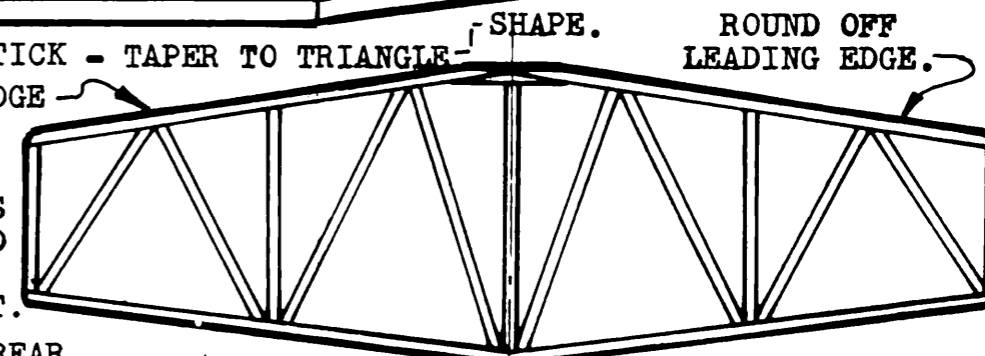

TAPER ALL TAIL TRAILING EDGES TO A STREAMLINED SHAPE.

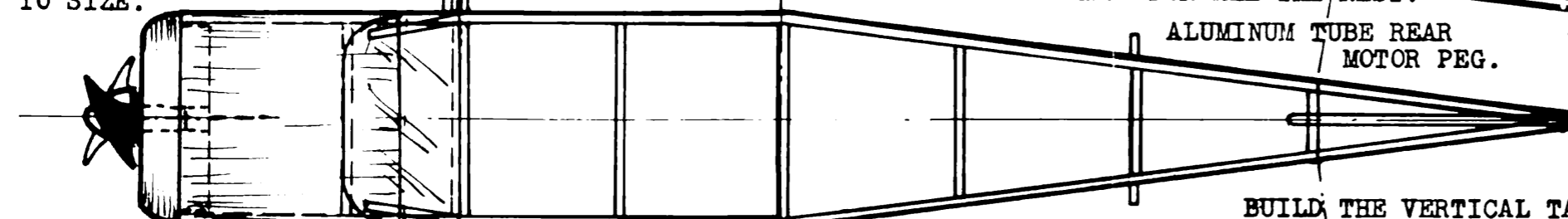

WINDSHIELD IS MADE FROM THIN TRANSPARENT PLASTIC, BUT WINDOWS ARE SIMULATED USING BLACK TISSUE FOR MINIMUM WEIGHT.

FAIRING, THIN SHEET OR PAPER.

TOP COWL BLOCK 1/4 INCH THICK. HOLLOW AS INDICATED BELOW.

BUILD THE VERTICAL TAIL SIMILARLY TO THE HORIZONTAL. USE 1/16 BY 1/8 FOR THE EDGES, TOP, AND BOTTOM.

BEND THE LANDING GEAR WIRE TO THIS SHAPE. USE .015 DIA MUSIC WIRE.

- (2) FROM 1/16TH
- (2) FROM 1/32ND
- (2) FROM "
- (9) FROM "

WING RIBS

VERTICAL TAIL

THE NOSE BLOCK IS MADE FROM TWO PIECES OF 1/4 INCH THICK Balsa. SECOND PIECE IS SHOWN BY THE DOTTED LINE AND FITS INTO FRONT OF NOSE.

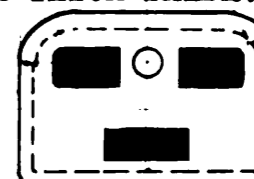

MAKE 2 COWL SIDES

"PECK POLYMERS" PLASTIC THRUST BUTTON IS USED.

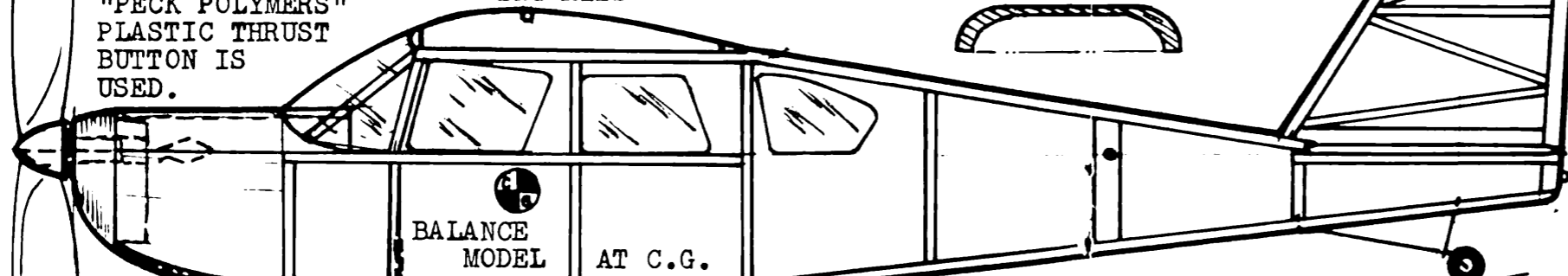

USE VERY THIN WIRE FOR TAIL LANDING GEAR. SIDE BRACE "V" MAKES IT A TRIPOD.

1/16TH SHEET.

COVER MODEL WITH WHITE LIGHTWEIGHT TISSUE OR CONDENSER PAPER. RED TISSUE TRIM. THE FUSELAGE IS A CONVENTIONAL FOUR LONGERON BOX. MAKE TWO SIDES DIRECTLY OVER THIS PLAN USING 1/16TH SQUARE FIRM Balsa FOR THE LONGERONS. USE SOFTER, LIGHTER WOOD FOR THE UPRIGHTS. REMOVE SIDES FROM PLAN AND SEPARATE. CEMENT TOGETHER AT REAR END AND ADD CROSSPIECES FORWARD TO WING T.E. CRACK ALL FOUR LONGERONS TO MAKE BEND, AND ADD FORWARD CROSSPIECES AND THEN COWL SIDES, TOP, AND BOTTOM.

THIS IS THE FOUND BROTHERS CENTENNIAL 100 A SIMPLE PEANUT

BY *Walt Mooney*

POWER - ONE LOOP OF 3/32ND RUBBER. TOTAL WEIGHT OF ORIGINAL MODEL - 1/2 OUNCE.