

CUT-AWAY ASSEMBLY ILLUSTRATION

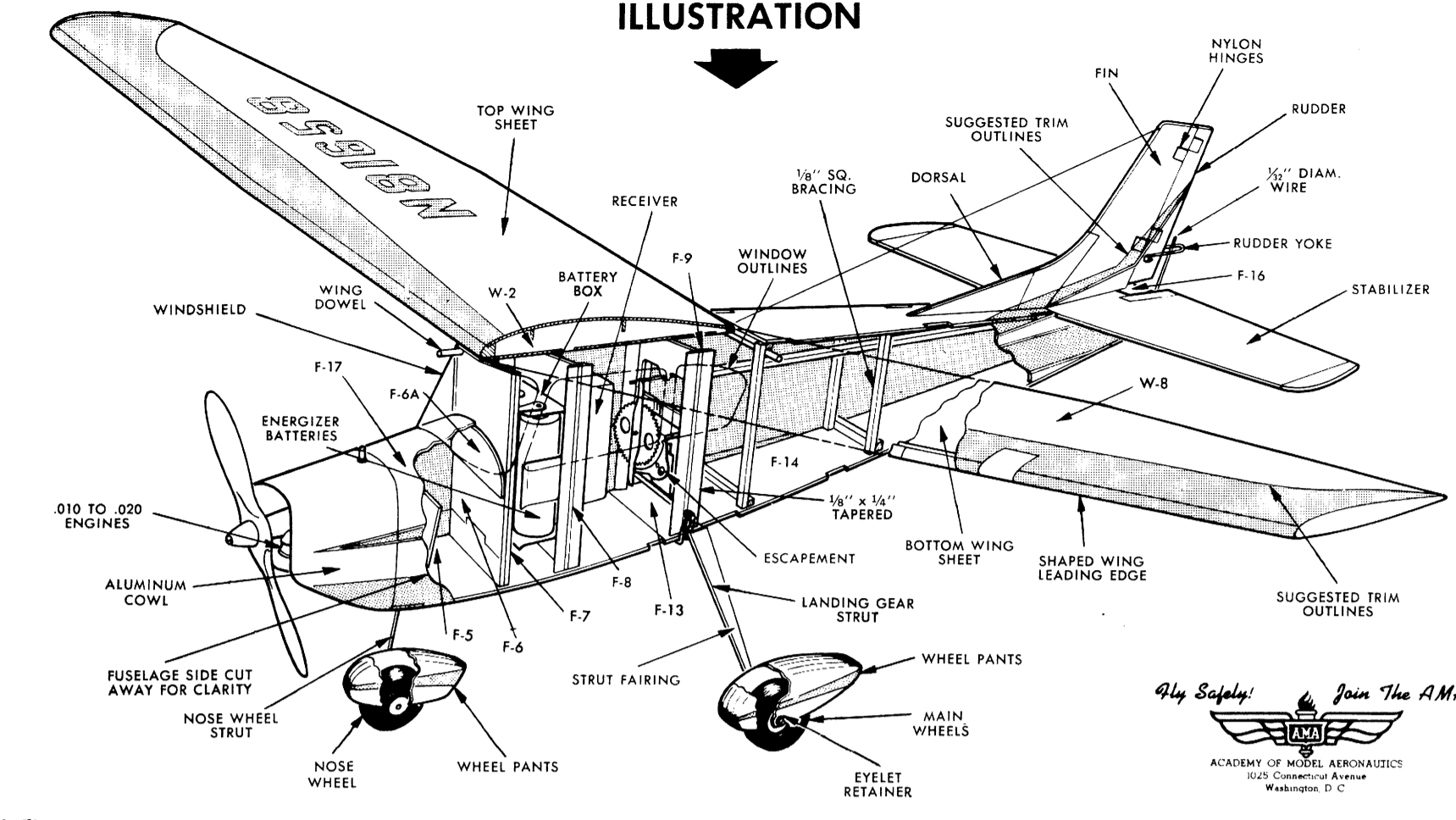

FUSELAGE AND TAIL ASSEMBLY

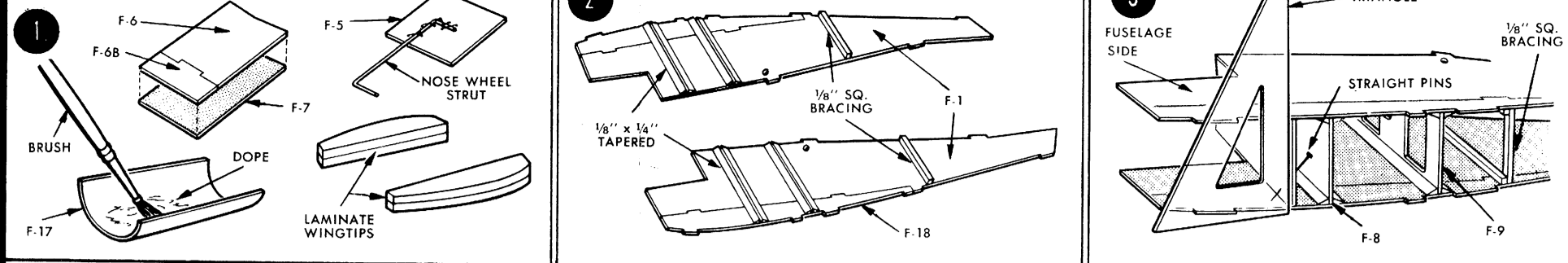

(1) Assemble and glue all parts to be laminated. (2) Sew nose wheel strut to former F-5. (3) Assemble and glue fuselage sides together with formers F-6, F-7, and cross brace. Tack cement F-8, F-9 Use triangle to position formers accurately. Pin down until glue dries.

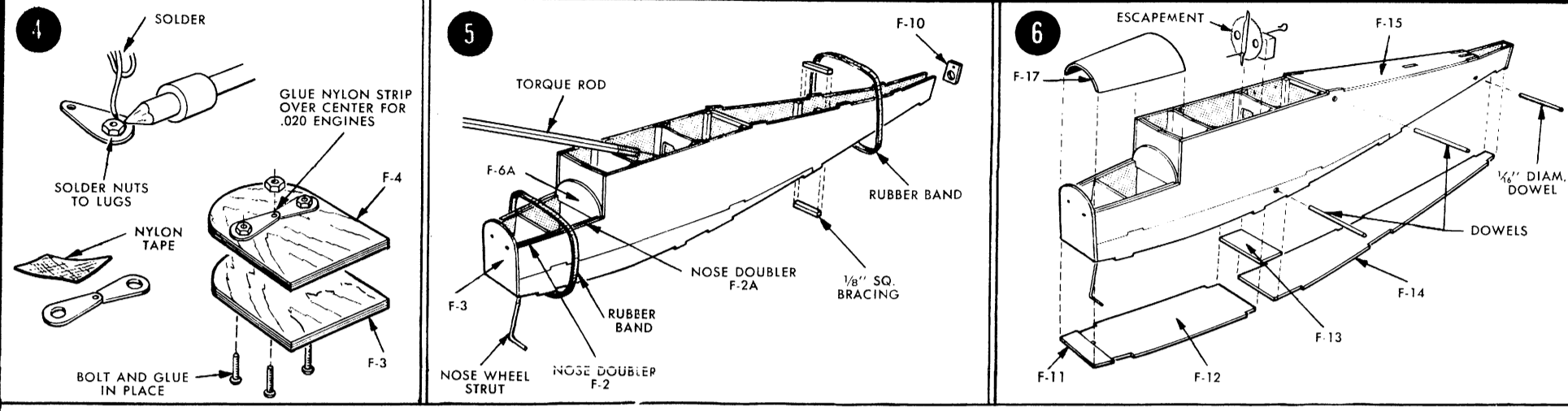

(4) Solder a nut to each of the two lugs provided. Drill holes in engine mount assembly for engine being used. (5) Insert torque rod thru escapement and mount in place. Add fuselage top and bottom sheeting. Glue F-17 and F-3 (firewall) in place. Cut small holes at dowel punch marks and insert thru. Glue dowels to inside of fuselage.

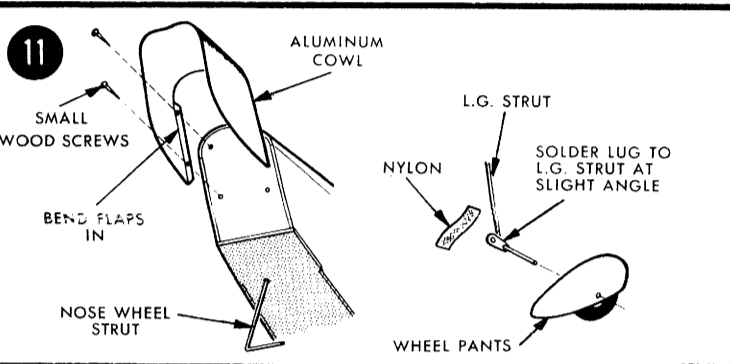
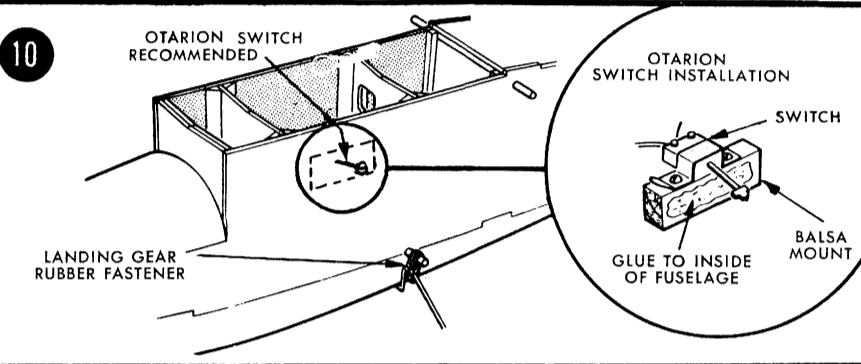
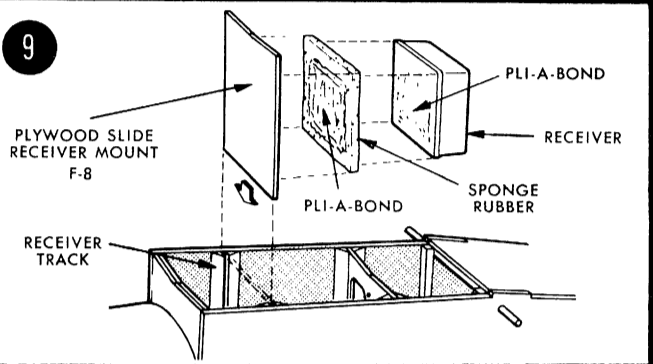
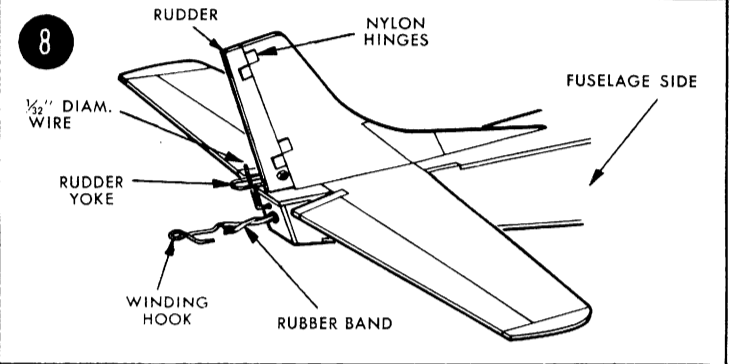
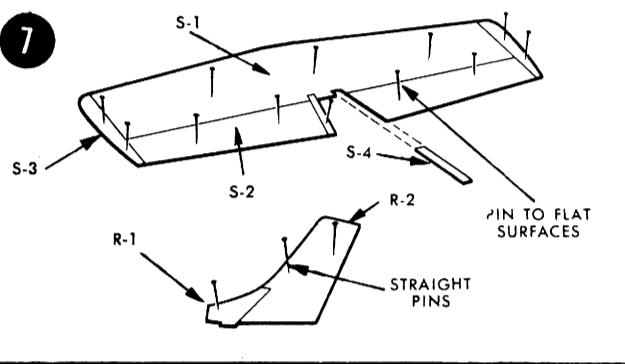
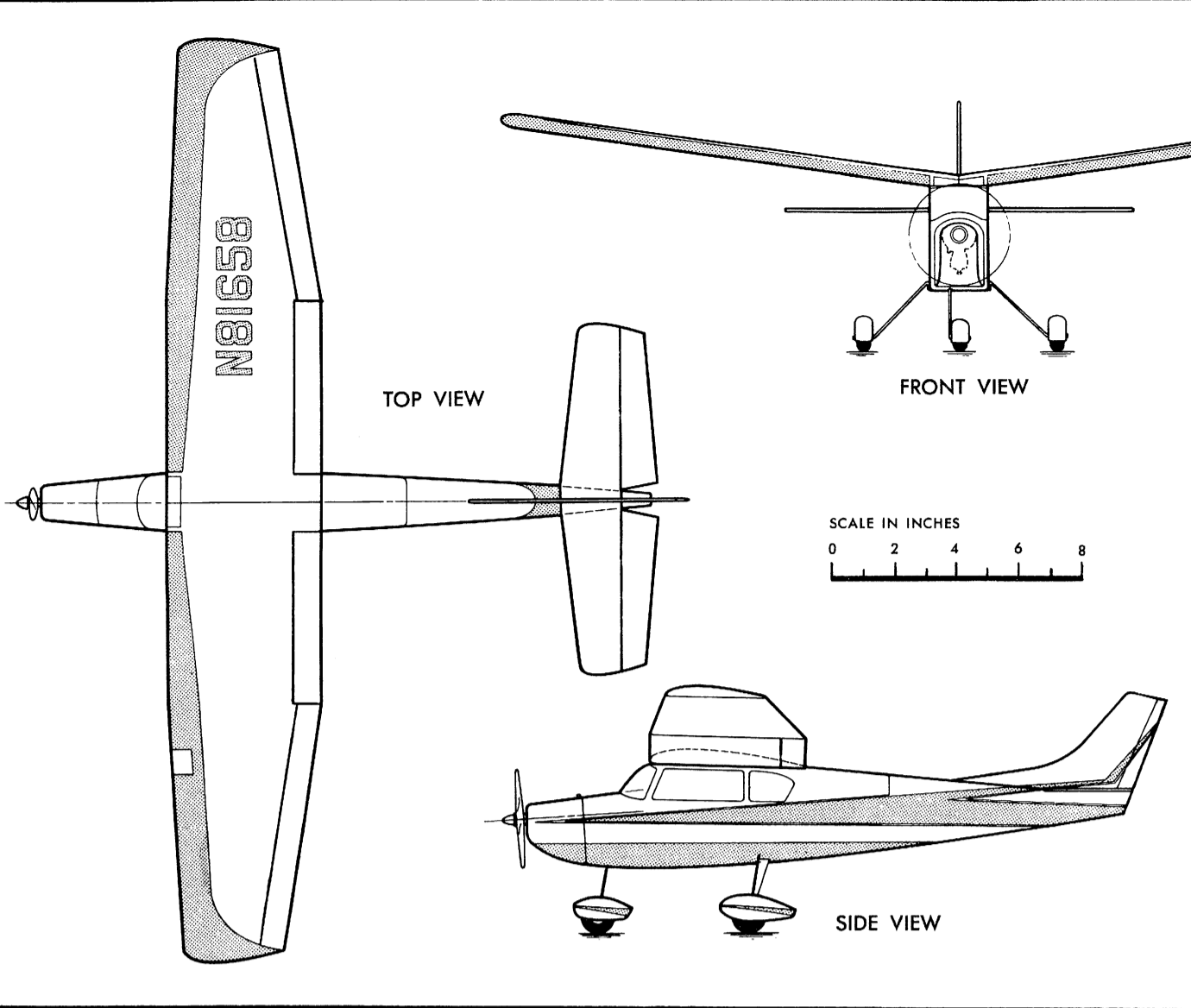

(7) Glue parts S-1, S-2, S-3 and S-4 together on a flat surface. Glue R-1, and R-2 together. Sand parts lightly. (8) Glue R-2 to stabilizer assembly. Check for correct alignment. Glue nylon hinge pieces to rudder and hinge to fin as shown. Bolt rudder yoke in place. Bend torque rod as shown.

Put winding hook on rubber loop and thread rubber through fuselage onto escapement hook. (9) Mount receiver as shown, using sponge rubber and Pli-A-Bond adhesive. For lighter weight, remove receiver cover.

(10) Cut hole for switch installation. An "Otarion" switch is recommended. Glue to inside of fuselage side. (11) Bend over flaps of die-cut aluminum cowl and attach to firewall with wood screws. Solder lugs at slight angle on

L.G. strut and locate wheel pants assembly on strut. Glue lug to pants and reinforce with nylon tape.

WING ASSEMBLY

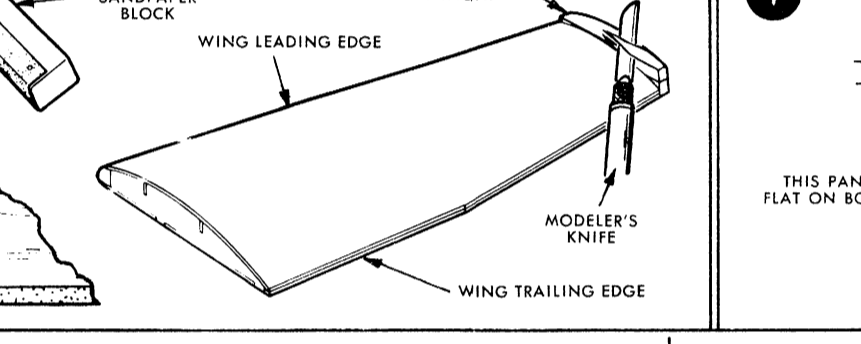
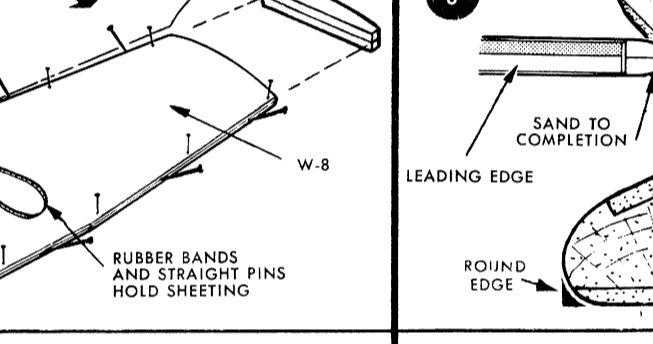
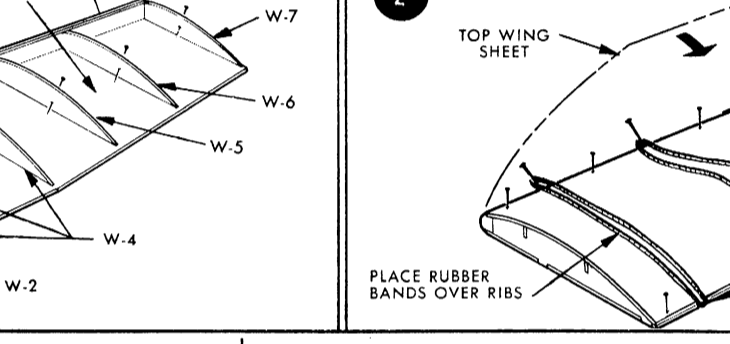
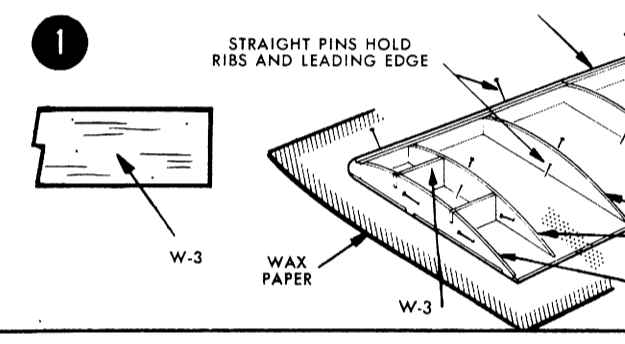

(1) Pin bottom sheeting to flat board. Shaped leading edge is cut at point of leading edge taper as shown. Glue center portion of leading edge in place, then add tip portion, angling back until it is properly aligned with bottom sheet. Then glue wing ribs and braces into notches. (2) Glue

top sheeting to wing leading edge and hold with pins. Then bend over and glue to wing ribs and at trailing edge. Hold in place with pins and do not remove from board until glue has thoroughly dried.

(3) Glue laminated wingtips at tip edge of each panel. When thoroughly dry, trim to rough shape with knife or single edge blade. Afterwards, smooth-sand to desired cross section. Round off bottom of wing leading edge. (4) Take the two finished panels and trim off all remaining excess. Butt join

the wing panels together with the correct dihedral. Cement nylon to the center-section and apply several coats of glue. When thoroughly dry smooth sand the entire wing.

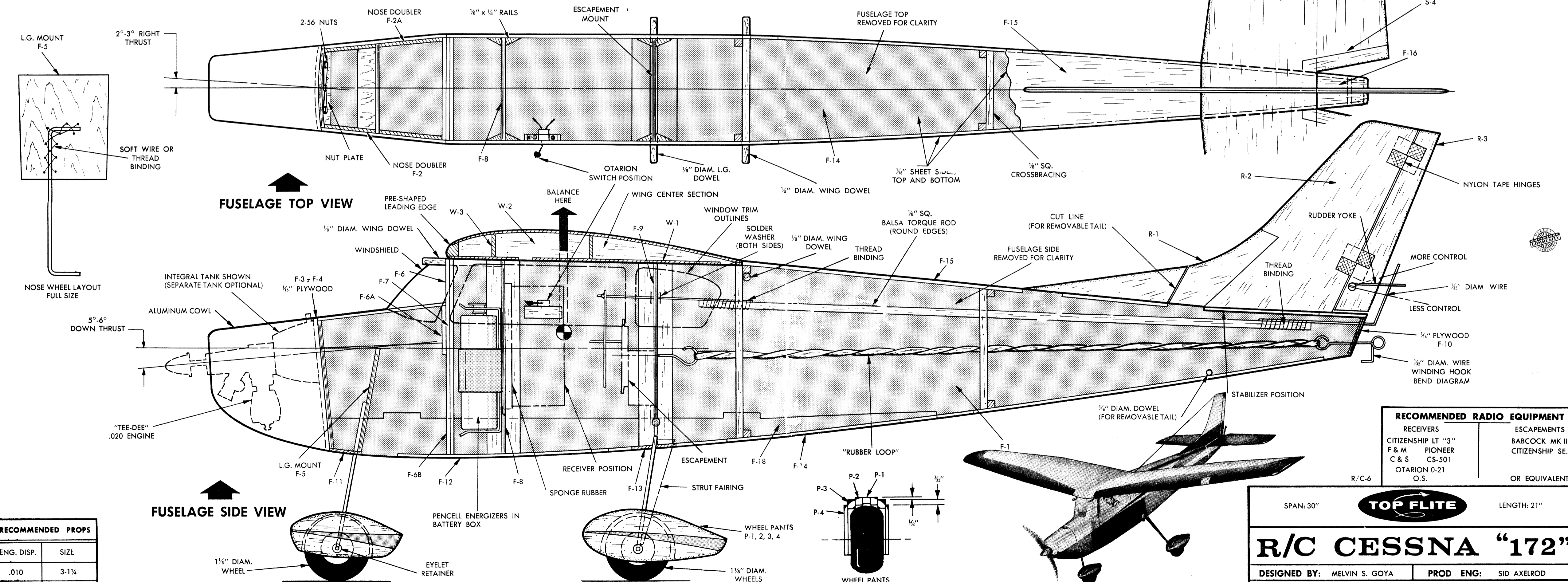

ENG. DISP.	SIZE
.010	3-1/4
.020	T.F. NYLON 5/4-3

RECEIVERS	ESCAPEMENTS
CITIZENSHIP LT "3"	BABCOCK MK II
F & M PIONEER	CITIZENSHIP SE.
C & S CS-501	
OTARION 0-21	
O.S.	OR EQUIVALENT

SPAN: 30" **TOP FLITE** LENGTH: 21"

R/C CESSNA "172"

DESIGNED BY: MELVIN S. GOYA PROD ENG: SID AXELROD

ILLUSTRATED BY: PAUL E. DEL GATTO

FOR .010 TO .020 ENGINES