

NOTE: ALL RIBS ARE CUT FROM 3/32" SHEET Balsa. NUMBER IN () INDICATES REQUIRED NUMBER.

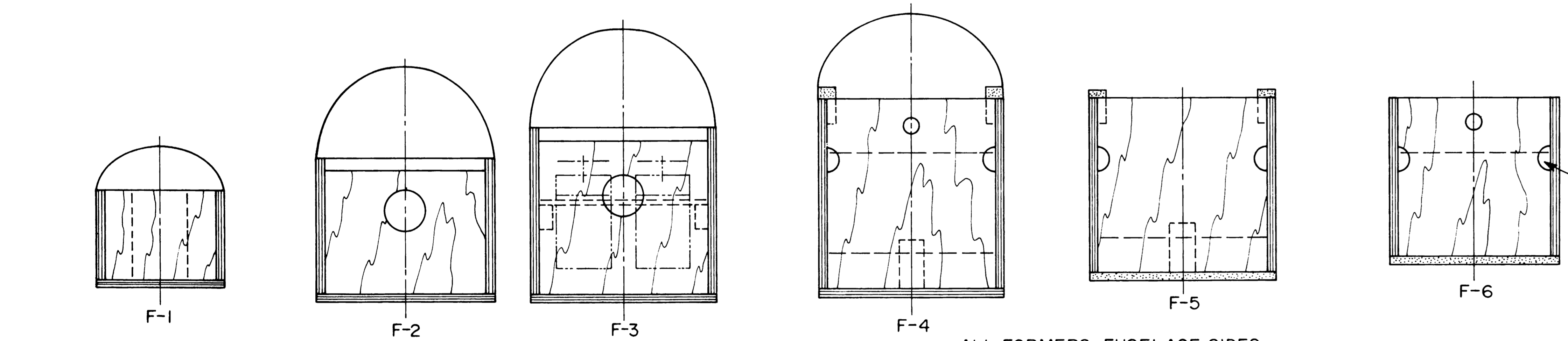

ALL FORMERS, FUSELAGE SIDES & BOTTOM ARE 1/8" POPLAR PLY

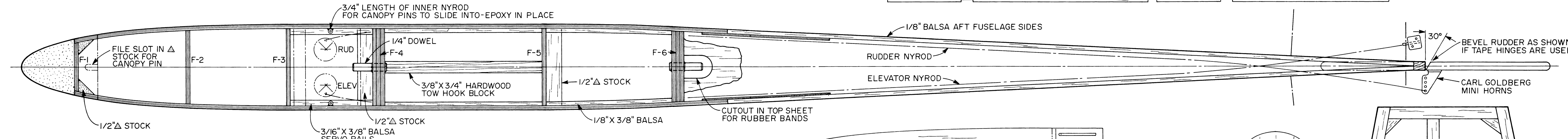
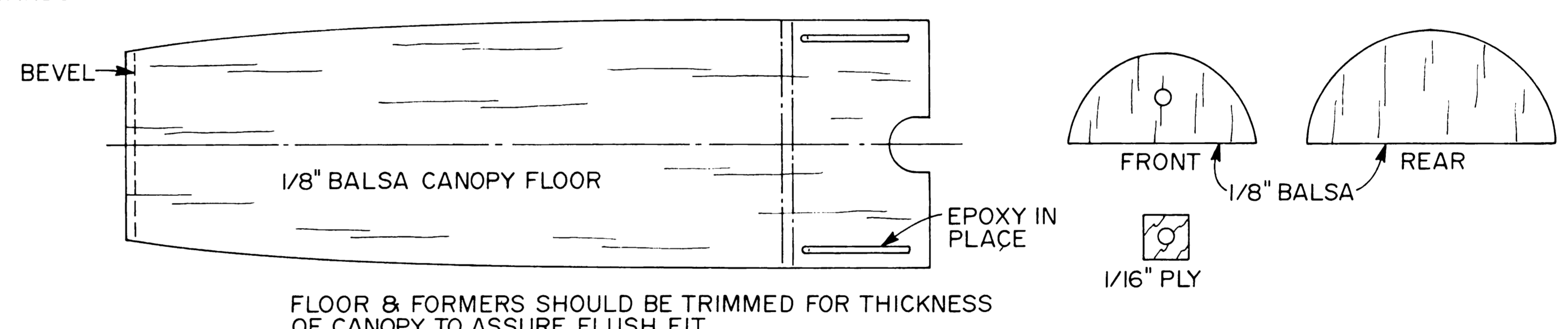

FLOOR & FORMERS SHOULD BE TRIMMED FOR THICKNESS OF CANOPY TO ASSURE FLUSH FIT.

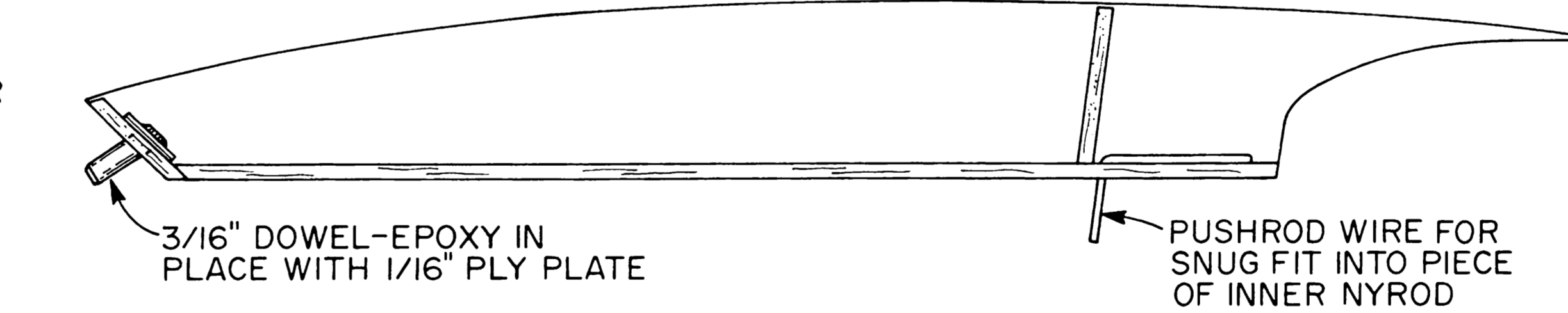

CLEAR CANOPY NOW AVAILABLE FROM
 HI JOHNSON MODEL PRODUCTS
 11015 GLENOAKS BLVD.
 PACOIMA, CA. 91331 \$3.00 POST PAID

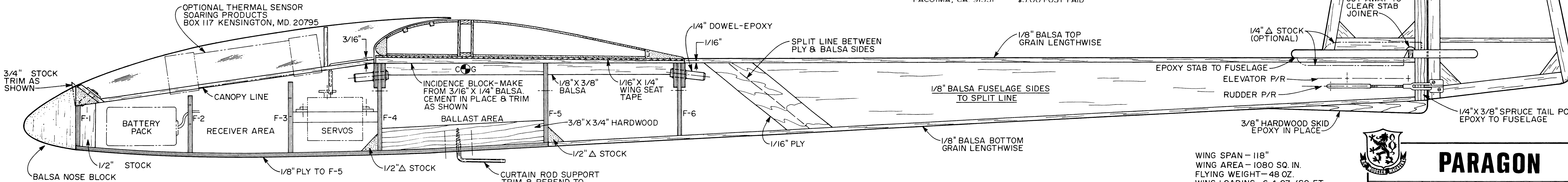
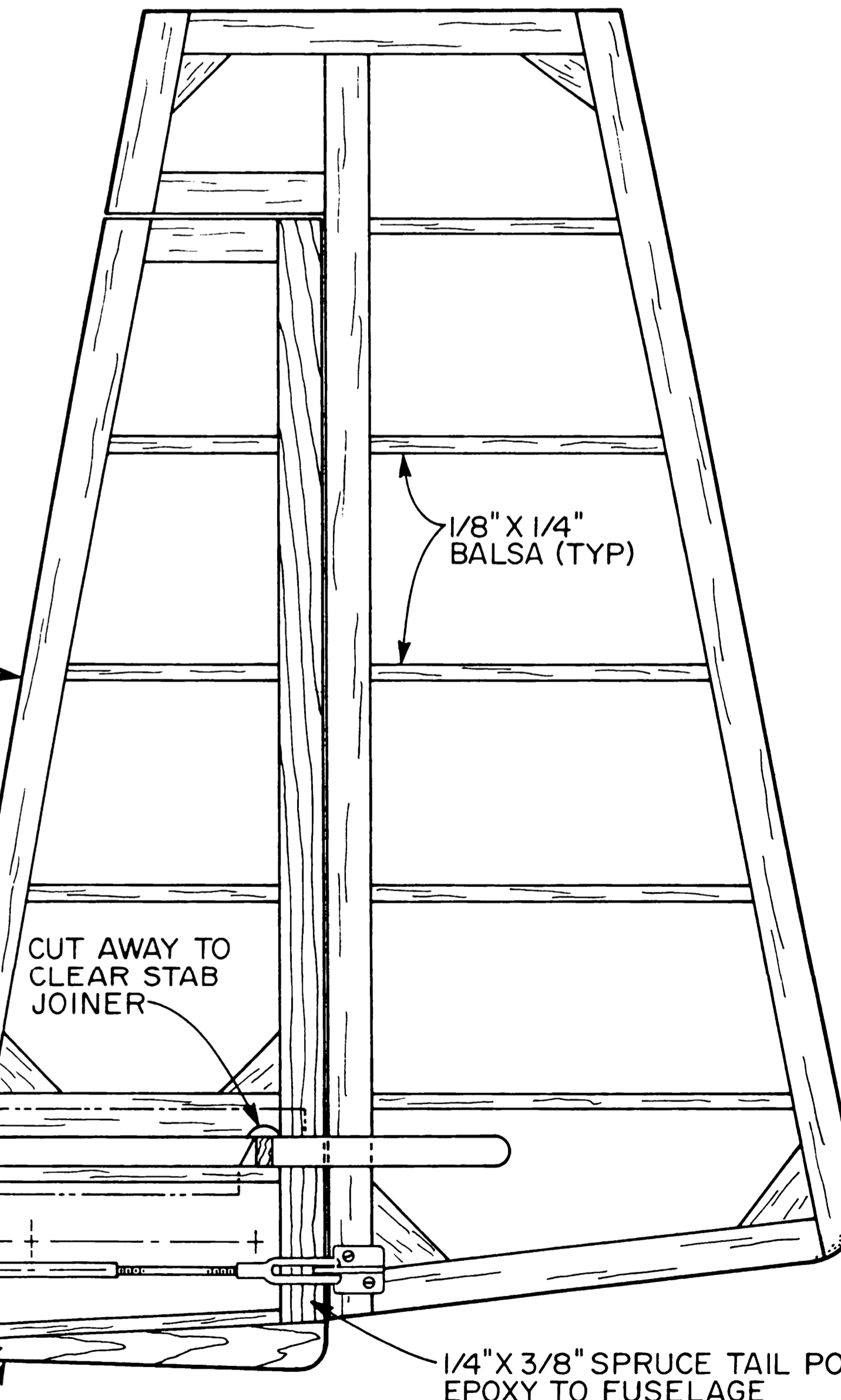

NOTE: IF "BRICK" IS USED INSTALL BETWEEN F-2 & F-3. RELOCATE F-3 AFT TO SUIT

WING SPAN - 118"
 WING AREA - 1080 SQ. IN.
 FLYING WEIGHT - 48 OZ.
 WING LOADING - 6.4 OZ./SQ. FT.

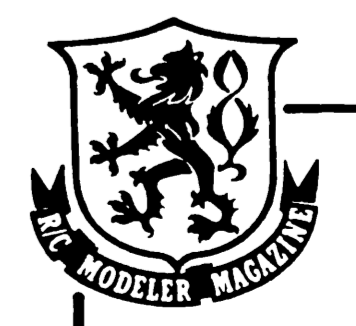

PARAGON

DESIGNED & DRAWN BY	ED SLOBOD	INKED BY	DICK KIDD
PIERCE AERO CO.			
9626 JELICO AVE., NORTHRIDGE, CAL. 91324			

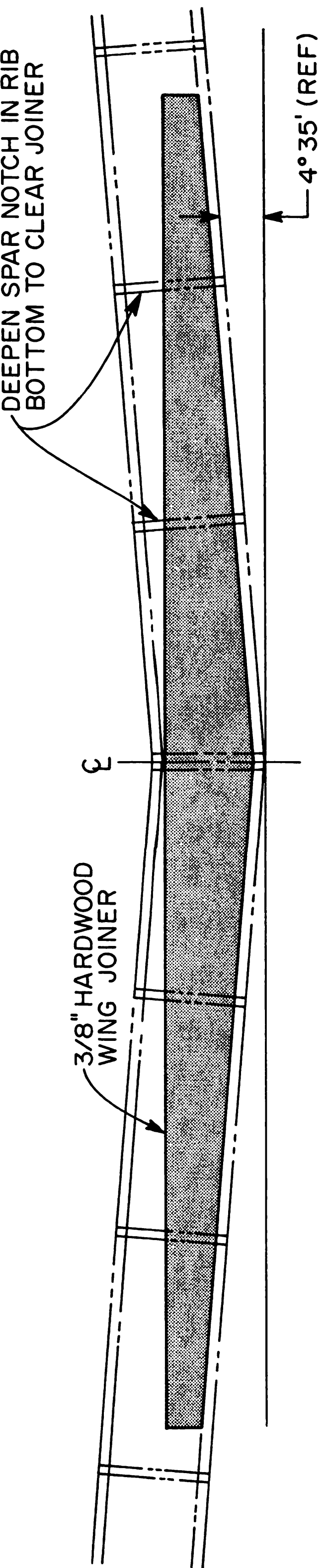
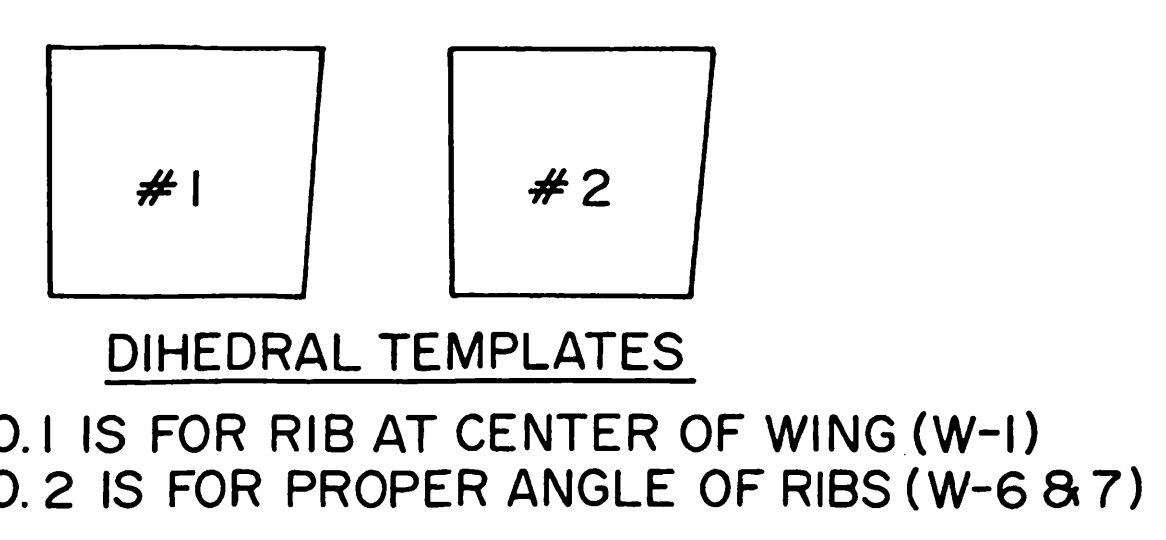
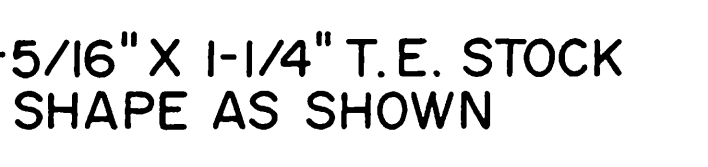
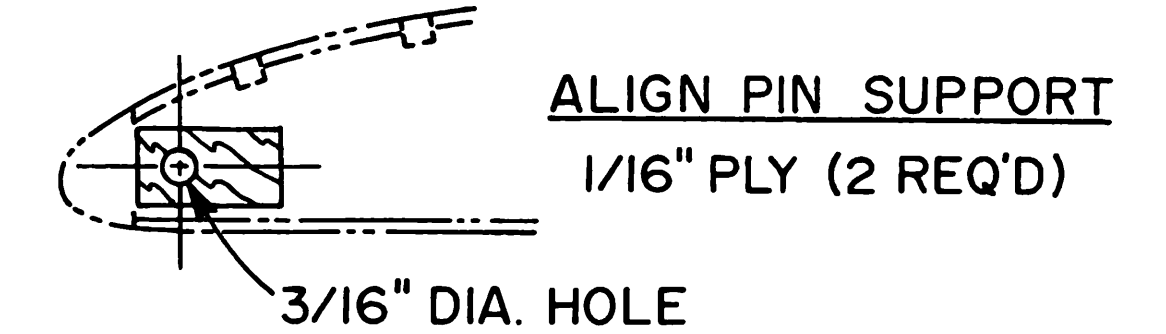
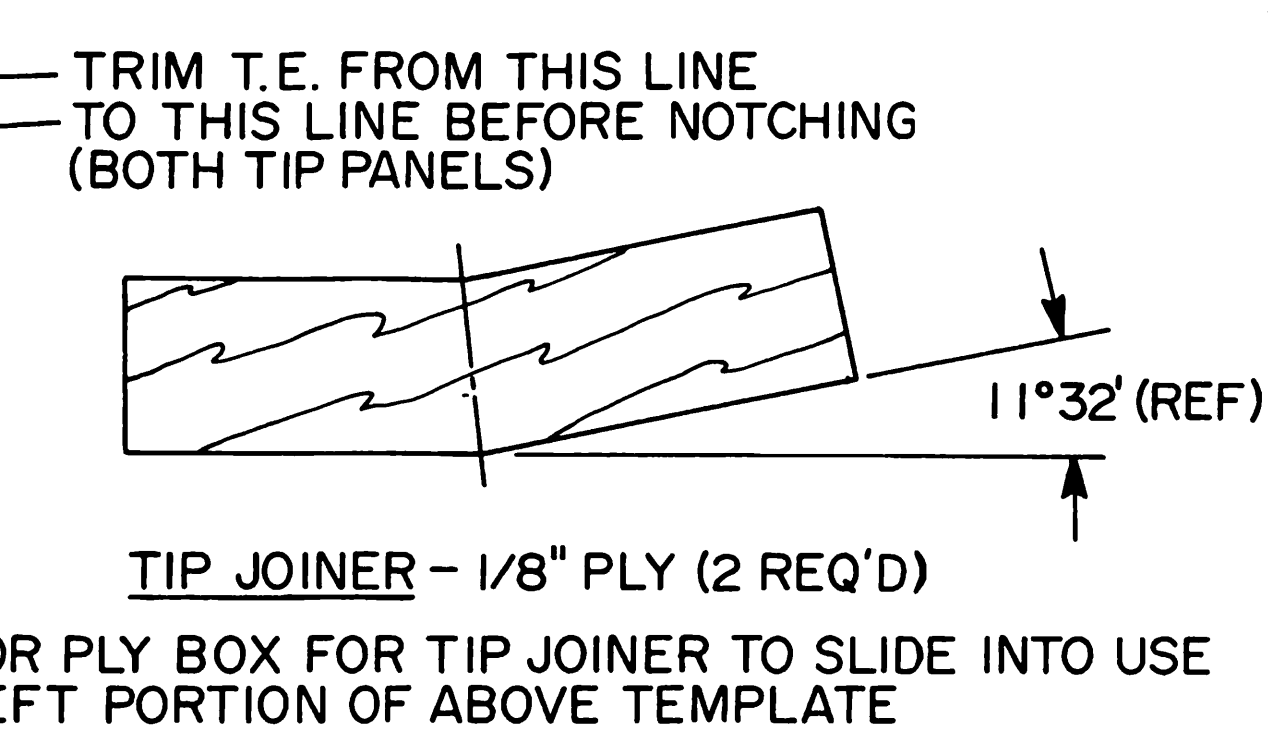
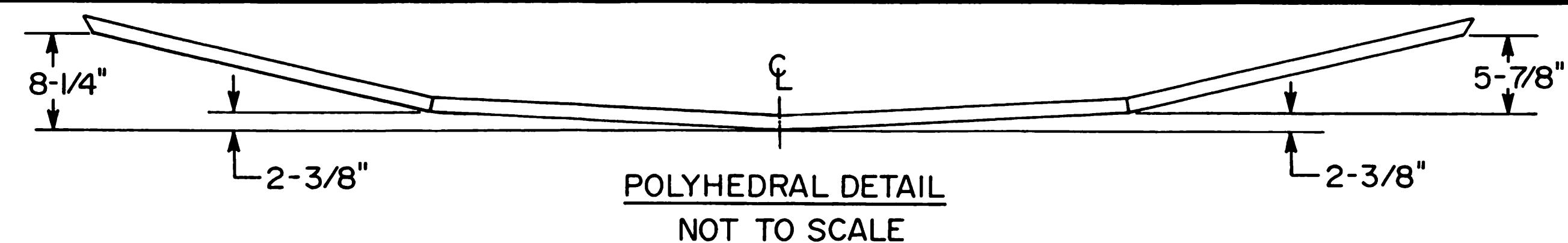
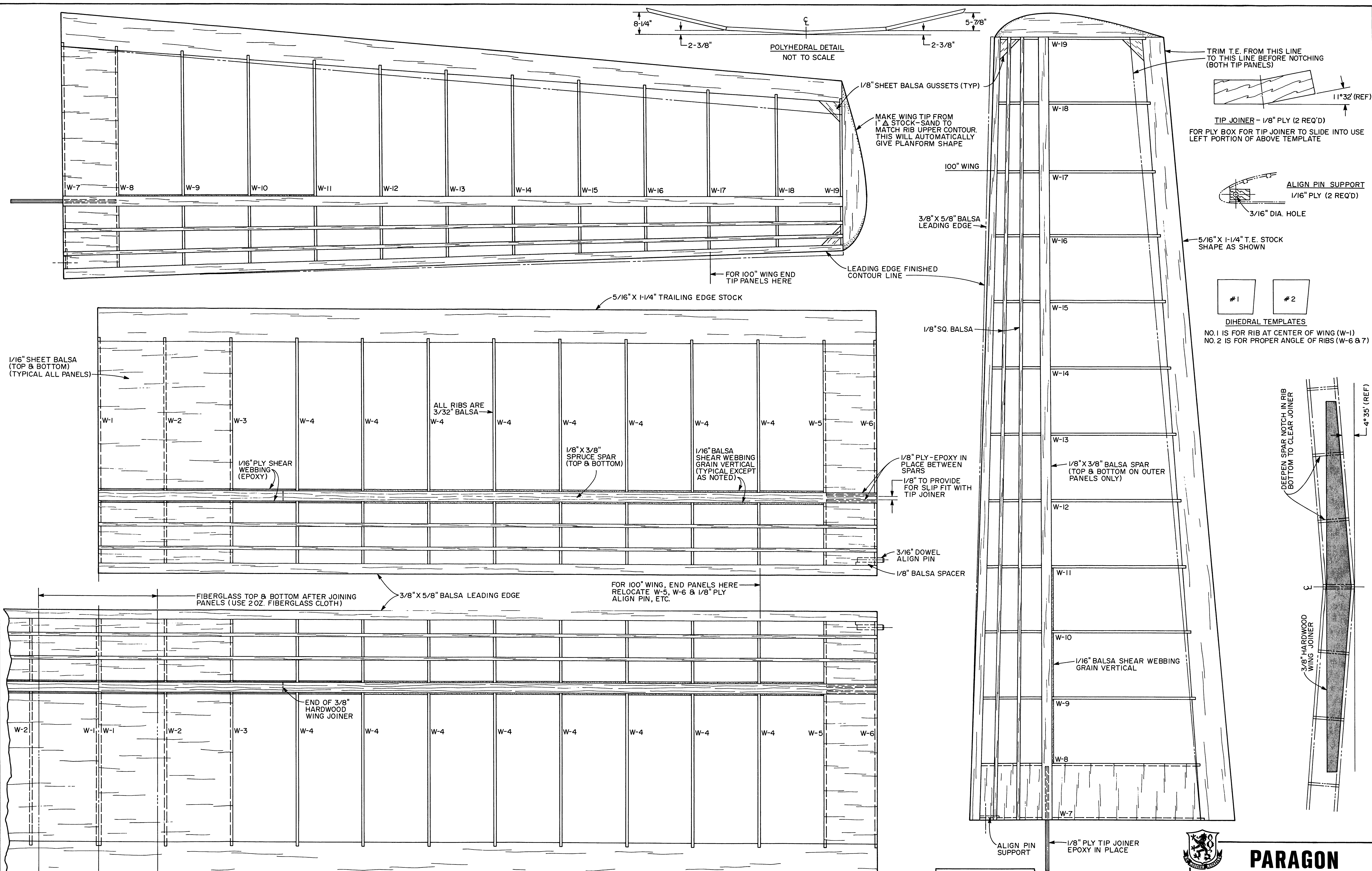

WING PLAN SHOWN FOR 120" WING. FOR 100" WING OMIT PORTIONS NOTED

NOTE: W-1, 2, 3, 5 & 6 ARE IDENTICAL

PARAGON

DESIGNED & DRAWN BY	ED SLOBOD	INKED BY	DICK KIDD
PIERCE AERO CO.			
9626 JELICO AVE., NORTHRIDGE, CAL. 91324			